

# #1109 - 4567 Lougheed Hwy, Burnaby

\$525,000



Welcome to the Amazing Brentwood Tower 3 - Twenty-eight acres at Willingdon and Lougheed of premier residential, shopping, entertainment and social community unlike anything this region has ever seen. This perfectly laid out 1 Bedroom faces North away from the Skytrain and busy Lougheed Highway. Chef's kitchen include a integrated Bosch Stainless Steel appliances with 4-burner gas cooktop, European cabinetry, designed kitchen island with breakfast bar, and floor to ceiling cabinetry providing up to 40% more storage area. Amenities include Over 26000 sq. ft. of private amenity space including: Outdoor BBQ Area, Guest Suites, Fitness Centre, Music Room and more. Extra Large DECORATING ALLOWANCE – Please contact for details. 1 parking and storage Locker included. \*\*\*Assignment of contract\*\*\* Estimated completion Late 2020

## KEY INFORMATION

PRICE: \$525,000

ADDRESS: #1109 - 4567 Lougheed Highway

AREA: Brentwood

TYPE: 1 Bedroom + Large Balcony

BATHROOMS: 1

SQ FT: 540 Interior + 174 Balcony

## FEATURES

STRATA FEES: \$264.71

PARKING: 1

STORAGE: Yes - Locker

VIEW: North - Quiet Side

ORIGINAL PRICE: \$339,200 (15% Deposit)

DISCOUNTS: \$16,960

COLOUR SCHEME: Modern Grey



**Derek Kai** PREC\*  
604.868.1666  
dkai@rennie.com  
rennie.com/derekkai

**rennie**



# PLAN A

1 BEDROOM + 1 BATH  
540 SF (OUTDOOR: 139-174 SF)

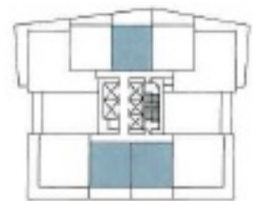

**Derek Kai** PREC\*  
604.868.1666  
dkai@rennie.com  
rennie.com/derekkai

**rennie**

\* PERSONAL REAL ESTATE CORPORATION. THIS COMMUNICATION IS NOT INTENDED TO CAUSE OR INDUCE A BREACH OF AN EXISTING AGREEMENT(S). E. & O.E